

The dual role of Community Networks

Panayotis Antoniadis

GAIA meeting @ IETF-96

Berlin, July 21st 2016



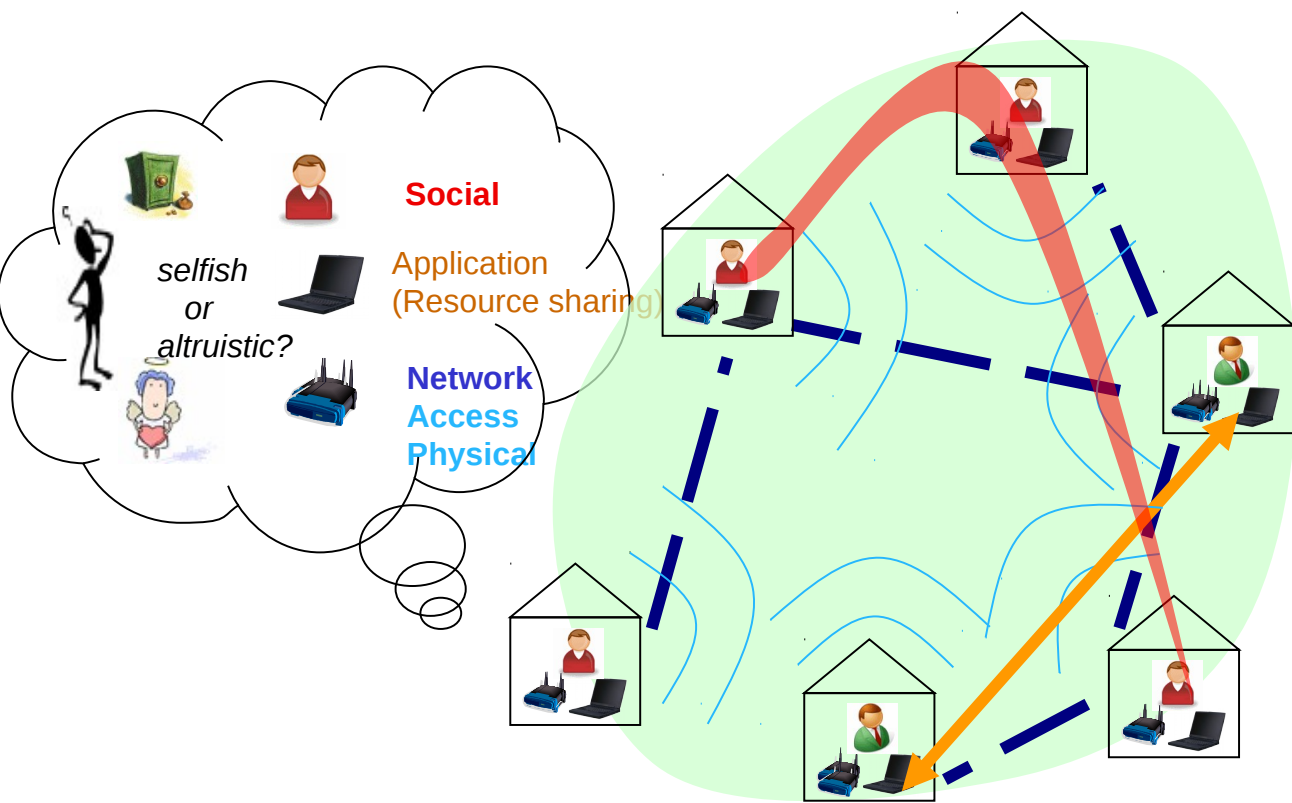

Antoniadis et al. (2008). Community building over neighborhood wireless mesh networks, IEEE Internet and Society.

Facebook helps you connect and share with the people in your life.



NetHood helps you connect and share with the people in physical proximity



Apostol, Antoniadis, and Banerjee, "From Face-block to Facebook or the other way around?", Sustainable City and Creativity, Naples, 2008

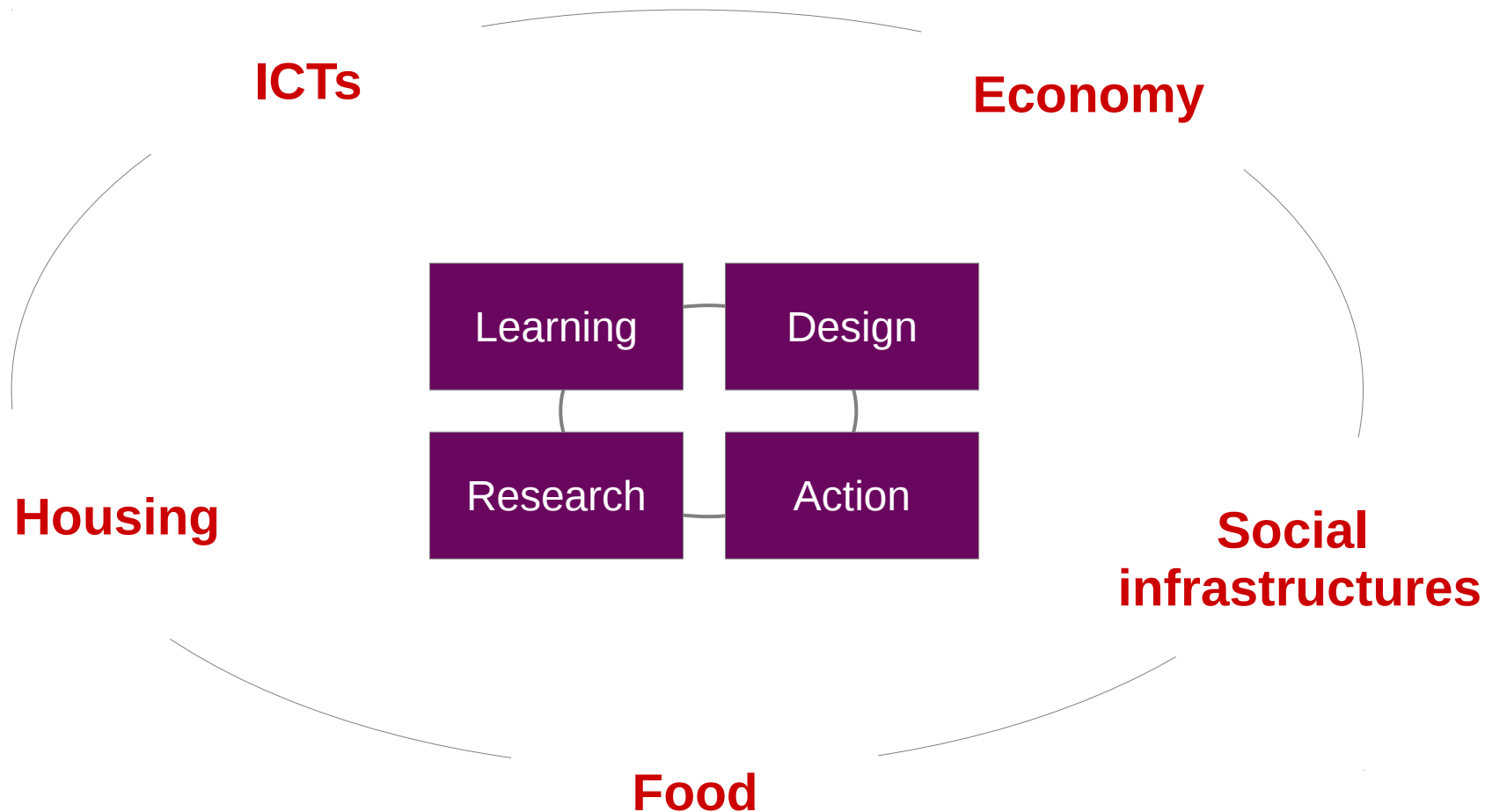

Community Networks and Do-It-Yourself Networking



BYO-wifi network

WIFI-CAPABLE DEVICE
iPhone, non-jailbroken

PORTABLE BATTERY
TeckNet IEP387

TRAVEL WIFI ROUTER
TP-Link TL-WR703N

USB THUMB DRIVE
8GB, formatted ext4

USB CABLE
USB2 Micro B / USB2 Type A
(comes bundled with the wifi router)

 occupyhere.org

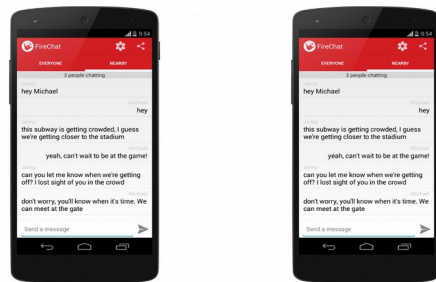

firechat



join free qaul.net



[GUILF.NET AVUI](#)
[SERVEIS](#)
[ARTICLES RECENTS](#)
[NOUS TEMES DE DEBAT](#)

31.057 nodes operatius

- ▶ 34.541 enllaços de xarxa
- ▶ 56.480,3 quilòmetres d'enllaços totals
- ▶ 123 nodes creats la darrera setmana
- ▶ 47 nodes passats a operatiu la darrera setmana

Nodes operatius

[més informació](#)

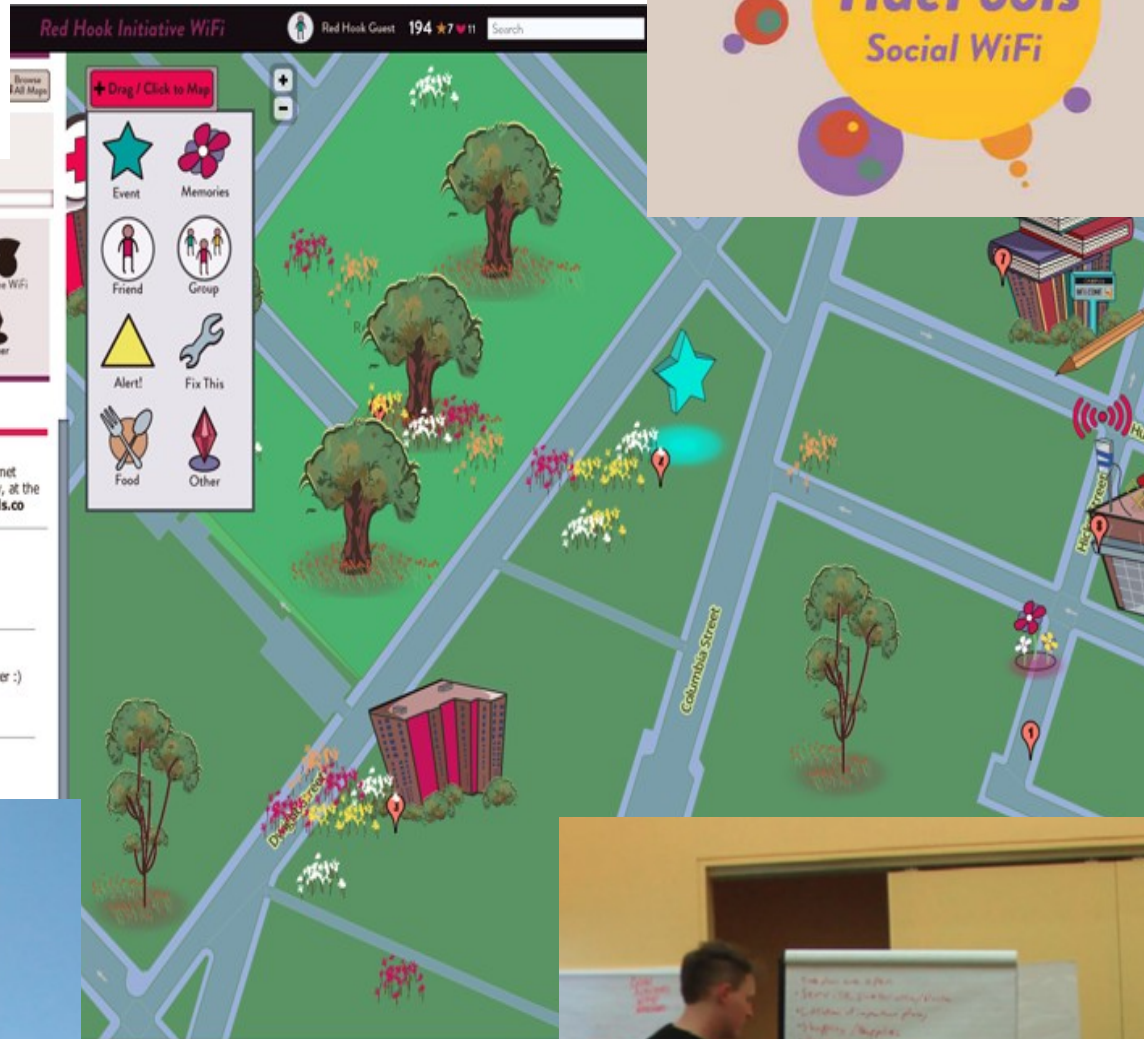

Ninux.org Nodi Attivi: 366 Hotspots: 24 Nodi Potenziali: 2252 Link Attivi: 1

Cerca un nodo, device, IP, MAC

Map Satellite

Mappe: Mappa Info OLSR VPN

Benvenuti nella rete Ninux!

+ Aggiungi un nuovo nodo

→ Nascondi questa colonna

🔍 Cerca un indirizzo

📊 Statistiche

Visualizza nodi potenziali

Visualizza la qualità dei collegamenti:

Disabilitato

Pacchetti persi (ETX)

Segnale ricevuto (DBm)

Lista dei nodi

Nodi Attivi

- [GLM] Isabeau
- [GLM] NukeHome
- [GLM] NukeStudio
- [GLM] Sonic0
- [GLM]Efalcor3
- 61615m1::Brodolini
- A68Castro
- A68Giordani
- A68lastorta
- Acquapagana
- Adrianco
- Alberata
- Ale-Nord
- Alex Genza Montecagnoletto
- Alex tsl Diomede
- Algemfeac
- Alife
- Allakatalla
- Allakatalla-2
- Allakatalla-3

“The aim of ninux.org is the creation of an urban intranet for experimental purposes only, so no Internet.”

Internet
access

guifi·net



Local
services

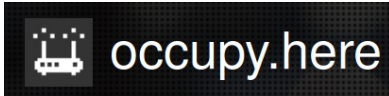

Introvert

Extrovert

Why local?

- Practical: inclusiveness, de facto proximity
- Social: contact, community, trust
- Political: participation, ownership
- Educational: social learning
- Scientific: open data

+ incentives for participation in Cns
beyond "filling the gaps"

Plaza Díaz Vélez

www.facebook.com/plazadiazvelez

DIALOGÁ • PARTICIPÁ • CONTÁ • COMUNICÁ

CONSTRUCCIÓN CIUDADANA
POR EL BIEN DE TODOS



Buenos Aires Ciudad

How?

- Build specialized self-hosted FLOSS applications
- Engage experts and local actors in the design process
- Address social, economic, legal, and political issues
- Create links with other “commoning” projects
- Build toolkits and scale through replication
- Think outside the Internet

Local networks for local interactions is not how “things used to be in the past” but how they could be in the future ...

Two Horizon2020 projects

- CAPS: Collective awareness platforms for sustainability and social innovation
- MAZI, <http://mazizone.eu>
 - 9 partners, 4 pilot studies, 1.8M EUR for 3 years
- netCommons, <http://netcommons.eu>
 - 6 partners, 2.3M EUR for 3 years

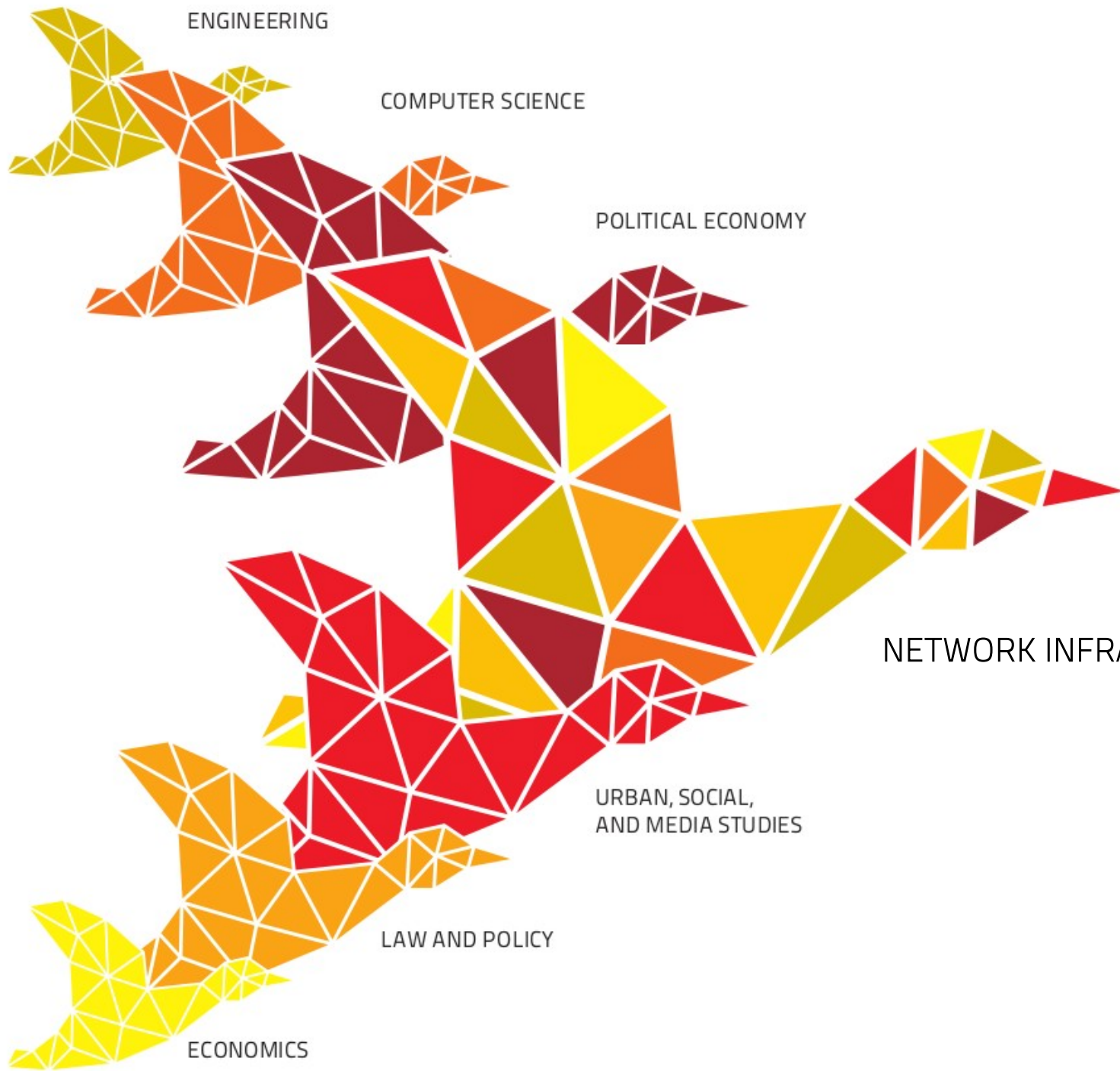

<http://netcommons.eu> – @netcommons



UNIVERSITY OF
WESTMINSTER

NetHood



European
Commission

Horizon 2020
European Union funding
for Research & Innovation





Universität der Künste Berlin

NetHood

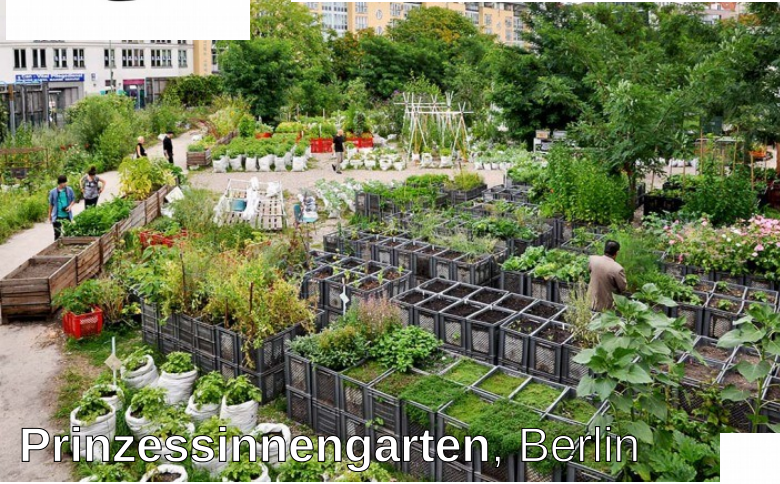

MAZI

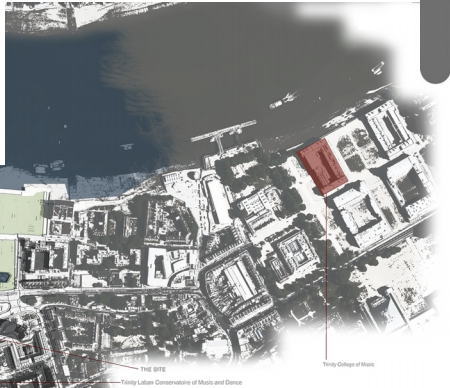

SPC

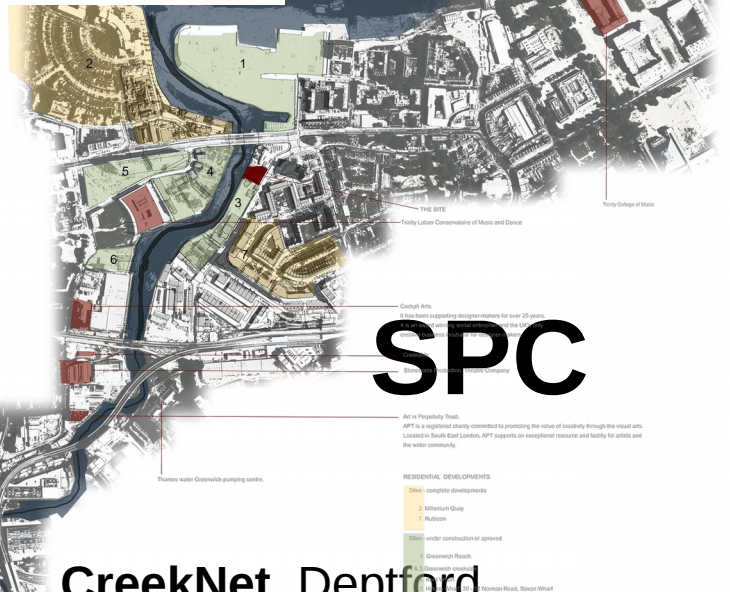

CreekNet, Deptford

